

Naco Ground Storage Tank Rehabilitation Project

Kathleen Price, P.E.

Manager – Engineering

Michael Robbins, E.I.T.

Graduate Engineer II

Fred Flores

Contract Administrator

Kendall NeSmith, P.E.

Engineer of Record

Marisol V. Robles

SMWVB Program Manager

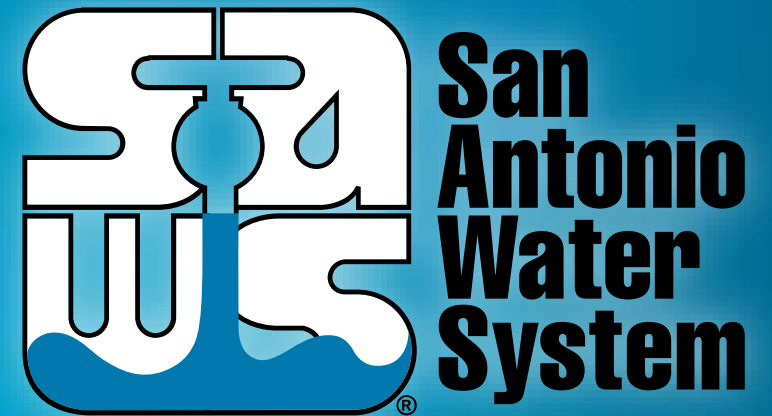

Pre-Proposal Meeting

December 9, 2019

MAKING SAN ANTONIO
WATERFUL 

Meeting Agenda

- Oral Statements
- Objective
- General Information
- RFCSP Schedule
- Contract Requirements
- Required Experience
- RFCSP Evaluation Process
- Scoring Criteria
- SMWB
- Communication
- Proposal Packet Preparation
- Vendor Registration
- Key Reminders
- Project Location Map
- Contract Requirements
 - Supplemental Conditions
 - Special Conditions
- Project Details
- Unique Project Features

Oral Statements

Oral statements or discussion during the pre-proposal meeting today will not be binding, nor will it change or affect the terms or conditions within the Plans and Specifications of this Project. Changes, if any, will be addressed in writing only via an Addendum.

Objective

Sealed proposals are requested by the San Antonio Water System for the rehabilitation and painting of a 7.5 MG ground storage tank for the Naco Ground Storage Tank Rehabilitation Project and is accepting Proposals which will require a Scope of Services to be performed by a qualified Contractor.

General Information

- This is a non-mandatory pre-proposal meeting.
- This presentation and the sign-in sheet will be posted to the SAWS website.
- The construction estimate is \$1,884,210.00
- Construction services being procured through Request for Competitive Sealed Proposal (RFCSP)
- Completion is scheduled for 240 calendar days.

RFCSP Schedule

Questions Due

December 10,
2019
4:00 PM (CT)

Proposals Due

December 20,
2019 10:30 AM
(CT)

Board Award
February 12, 2020

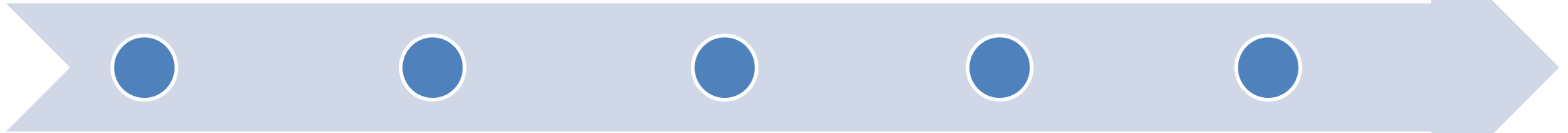

Answers Posted

December 13,
2019
4:00 PM (CT)

Lowest Responsible Respondent Notified

December 2019

Contract Requirements

Prevailing Wage Rate and Labor Standards – Section 2.10 of the General Conditions

- Certified payroll to be submitted on weekly basis
- Wage decisions are included within the specifications
- Contractors to utilize LCP Tracker
- Site visits are random and unannounced
- Interviews will be Conducted and will be private & confidential
- Payroll records are subject to review
- All apprenticeship programs will need to be approved by Department of Labor prior to starting
- Contractors are responsible for sub-contractor payroll
- Late payrolls delay contractor payments from SAWWS

Contract Requirements

- Insurance requirements are found in Section 5.7 of the GCs
 - Builder's Risk is waived and Installation Floater coverage is required (see Supplemental Conditions)
 - Riggers Liability coverage (see Supplemental Conditions)
 - Maintain insurance coverage during the construction of this Project
- Compliant prior to executing the contract
- Will ask for insurance prior to Board award to expedite execution of the contract
 - Any deficiencies must be corrected prior to Board award

Required Experience

- Experience with the rehabilitation of steel ground storage tanks for potable water, metal fabrication and welding
- Disinfection experience with AWWA C652, Method 2, and coating
- Close coordination with several key stakeholders including SAWWS & Texas Commission on Environmental Quality (TCEQ)
- Application specified in Sections 09910 and 09940

RFCSP Evaluation Process

- Technical Evaluation Committee (TEC) will score the proposals based on the evaluation criteria published in the Supplementary Instructions to Respondents to determine the Respondent who can provide the best value to SAWWS
- Price will be calculated (lowest price receives the highest points) and added to final scores
- SMWVB will be added to final scores
- Selection Evaluation Committee reviews final scores
- Negotiations, if any
- Board award

Scoring Criteria – Cont.

Supplemental Instructions to Respondents

I. Similar Experience and Qualifications	40%
i. Experience and Qualifications of Key Personnel	10%
ii. Past Performance on Similar Projects	15%
iii. Overall Experience and Qualifications of Prime and Subs	10%
iv. Safety Record	5%
2. Project Delivery Schedule and Available Resources	20%
i. Delivery Schedule	10%
ii. Reporting Structure, Availability of Key Personnel & Equipment	10%
3. Price	30%
4. SMWVB	10%

Scoring Criteria – Cont.

Supplemental Instructions to Respondents

i. Experience and Qualifications of Key Personnel

- Construction Project Manager, Construction Superintendent, QA/QC Person, forms and Competent person for Safety, and Foreman. Each team member must have worked on one of the projects in item ii.
- One page resume for each

ii. Past Performance on Similar Projects

- Three previous projects of similar scope completed in last five (5) years. One on an ground storage tank at least 5 MG capacity.

iii. Overall Experience and Qualifications of Prime and Subs

- Company information, sub-contractor information, potable tank projects completed in last five (5) years.

Scoring Criteria – Cont.

Supplemental Instructions to Respondents

iv. Safety Record

- TRIR and EMR with documentation.

i. Proposed Project Delivery Schedule

- NTP 2/17/2020, include milestones and completion by 10/17/2020

ii. Availability of Key Personnel & Equipment

- Projects underway, personnel availability, & equipment availability
- Organizational Chart

Scoring Criteria – Cont.

Supplemental Instructions to Respondents

Price

- Points based on lowest price of all bids. Lowest proposal gets 30 points with remaining proposals getting a percentage of 30 points based on how close their proposal are to the lowest.

Proposal	Price	Calculation	Points Earned
A	\$1,879,210.00	$(1,879,210/1,879,210) \times 30$	30.00
B	\$2,000,000.00	$(1,879,210/2,000,000) \times 30$	28.19
C	\$2,250,000.00	$(1,879,210/2,250,000) \times 30$	25.06
D	\$2,500,000.00	$(1,879,210/2,500,000) \times 30$	22.55
E	\$3,000,000.00	$(1,879,210/3,000,000) \times 30$	18.79

Scoring Criteria – Cont.

Supplemental Instructions to Respondents –

i. Experience and Qualifications of Key Personnel

Construction Project Manager (for this project)	
Name	
Number of Years and Months with Current Employer	
Number of Years of Experience in this Role	
Total Number of Years of Relevant Experience	
Relevant Certifications (provide Certificates or documentation)	
Proposed Availability (% time) for this Project	
Proposed Availability (% time) to be on-site for this Project	
Level of Proficiency developing project schedules in Microsoft Project or Primavera? (beginner, intermediate, expert, and which software)	
Who does the Project Manager report to in the company (name/title)	

Project Experience #1 (must be similar to this project)			
Project Name		City/State	
Name of your employer during project			
Project Start Date		Project Completion Date	
Volume (GAL) of Potable Water Tank:			
Material of Potable Water Tank:	<input type="checkbox"/> Steel	<input type="checkbox"/> Concrete	
	<input type="checkbox"/> Composite		
Lead Abatement:	<input type="checkbox"/> Yes	<input type="checkbox"/> No	
Type of coating & application used:			
The project's scope relevant to project:			
Elevated or Ground Potable Water Tank?			

Scoring Criteria – Cont.

Supplemental Instructions to Respondents

Past Performance on Similar Projects

Project Reference #1 (Prime Contractor - Respondent)	
Name of Project:	
City and State:	
OWNER's Name:	
OWNER's Contact Person	
OWNER's Valid Phone Number	
OWNER's Valid Email address	
Initial Contract Price:	
Final Contract Price:	
Contract Start Date: (Date of Notice to Proceed)	
Contract Completion Date:	
Actual Completion Date:	
Construction Project Manager	
Construction Superintendent	
QA/QC Person	
Competent Person for Safety	
Foreman	

Subcontractor(s)	
Name:	
Role:	
Number of years' of experience in this role:	
If contract time extensions/change orders were added to the contract, provide a short explanation of each:	
Please describe how it is comparable to this Project AND check all applicable boxes below:	
<p>(Check all that applied to this project)</p> <input type="checkbox"/> Metal fabrication and welding <input type="checkbox"/> High solids fluoropolymer exterior finish <input type="checkbox"/> 100% Solids Elastomeric Interior Coating <input type="checkbox"/> Containment system <input type="checkbox"/> SSPC-SP 6/NACE No. 3 Blast Cleaning <input type="checkbox"/> SSPC-SP 10 Near White Blast Cleaning	
Volume of Potable Water Tank (GAL):	
Material of Potable Water Tank:	
Lead Abatement: Yes or No	
Type of coating & application used:	
Elevated or Ground Potable Water Tank?	

Scoring Criteria – Cont.

Supplemental Instructions to Respondents

Overall Experience and Qualifications of Prime and Subs

Respondent Company Information	
Number of years in business under current Respondent's name	
Other Legal Names Respondent uses or has used in the Past	
Relevant Respondent's Certifications	
Number of employees as of 11/25/2019	

Sub-Contractor Company Information	
Sub-Contractor #1	
Company Name	
Address	
Number of employees as of 11/25/2019	
Phone Number	
Role for this project	
Years of experience in this role	
Number of years in business under current company name	
Other Legal Names Sub-contractor uses or has used in the Past	
Relevant Company Certifications	

Scoring Criteria – Cont.

Supplemental Instructions to Respondents

Overall Experience and Qualifications of Prime and Subs, Cont.

Respondent's potable tank projects completed in the past five (5) years (Fill out Completely, "See Attached" is not acceptable)						
Project Name	Location (City / State)	Owner	Tank Size (MG) & Type	Type of Work	Bid Amount	Contract Completion (Mo/Year)

Scoring Criteria – Cont.

Supplemental Instructions to Respondents

Safety Record

Safety Record						
1. Respondent's Total Recordable Incident Rate (TRIR) for the past 3 years (attach OSHA records)	2016		2017		2018	
2. Respondent's Experience Modification Rate (EMR) for the past 3 years (attach documentation from Texas Department of Insurance)	2016		2017		2018	
3. List any fatalities in the history of the Prime Contractor and describe the circumstances:						
4. Has the Respondent received an OSHA citation during the last three (3) years?					<input type="checkbox"/> Yes <input type="checkbox"/> No	

Scoring Criteria – Cont.

Supplemental Instructions to Respondents

Proposed Project Delivery Schedule

- Must include at least the milestones listed.
- Assume NTP date of February 17, 2020 and a completion date no later than October 17, 2020.
- Be realistic when estimating time for submittals. Work will not be allowed to start until all required submittals are approved.

Scoring Criteria – Cont.

Supplemental Instructions to Respondents

Availability of Key Personnel & Equipment

Respondent's current projects committed or underway (Fill out Completely, "See Attached" is not acceptable)					
Project Name	Contract Start Date	Contract Completion Date	Is the project on schedule?	Bid Amount	Brief Project Description
			Y <input type="checkbox"/> N <input type="checkbox"/>		
			Y <input type="checkbox"/> N <input type="checkbox"/>		
			Y <input type="checkbox"/> N <input type="checkbox"/>		
			Y <input type="checkbox"/> N <input type="checkbox"/>		
			Y <input type="checkbox"/> N <input type="checkbox"/>		

Scoring Criteria – Cont.

Supplemental Instructions to Respondents

Availability of Key Personnel & Equipment, Cont.

Available Workforce (Fill out Completely, "See Attached" is not acceptable)				
DISCIPLINE OR CRAFT	Name	NO. OF EMPLOYEES	COMMITTED TO ANOTHER PROJECT (Yes or No)	AVAILABLE / RELEASE DATE
Project Manager		N/A		
Superintendent		N/A		
Competent Person for Safety		N/A		
QA/QC Person		N/A		
Foreman		N/A		
Painting Crew	N/A			
Welders	N/A			
Equipment Operators	N/A			
Other				
Other				

Available Equipment (Fill out Completely, "See Attached" is not acceptable)			
EQUIPMENT for this Project	OWNED OR LEASED	COMMITTED TO ANOTHER PROJECT	AVAILABLE / RELEASE DATE



Aspirational SMWB Goal

Industry	Aspirational SMWB Goal
Construction	20%

Aspirational SMWB goal = 20% of total bid price.

Accepted SMWB Certification Agency

- **South Central Texas Regional Certification Agency**
(Includes the Texas Historically Underutilized Business “HUB” Program)

Minimum Qualifications for SMWB recognition:

- SBE-Certified (even MBEs and WBEs)
- ***Local office or local equipment yard***

Accepted SMWB Certifications

- Small Business Enterprise (SBE)
- Minority Business Enterprise (MBE) (Includes AABE; ABE; HABE and NABE)
- Woman-owned Business Enterprise (WBE)
- Up to 10 Points for SMWB participation.
- SAWS Reserves the right to Deduct up to 3 SMWB points for prior Non-Compliance with Board-Approved Goals on recent contracts. (Page SIR-25 of the Specifications Doc.)

Good Faith Effort Plan (GFEP) FAQs

- **Q: Is the 20% SMWB goal mandatory?**
A: No, but we ask prime contractors to do their best with good faith outreach efforts. If the goal is not met, proof of outreach efforts is required with the submittal.
- **Q: What if I am having trouble finding SMWB subcontractors?**
A: Please email the SMWVB Program Manager with the scopes of work you are seeking. You will receive lists of local SMWVB-certified firms to contact.
- **Q: What if my business is SMWB-certified? Do I need to find SMWB subs?**
A: If your firm is SMWVB-certified, you will most likely meet the goal. However, the GFEP is a required document, and a good faith outreach effort is still necessary.
- **Q: Do I need to include all my subcontractors in the GFEP or just those that qualify towards the SMWB goal?**
A: All subcontractors need to be included in the GFEP, even those that may not count towards the SMWB goal.
- **Q: What if I have questions about the GFEP?**
A: Please contact the SMWVB Program Manager at 210-233-3420, or at Marisol.Robles@saws.org. GFEP questions can be asked at any time before the submittal is due.

Post Award: Subcontractor Payment & Utilization Reporting (S.P.U.R.) System

- 1. Subcontractor & Supplier Payment Tracking, Changes, & LCP Tracker
- 2. Must be Current and Accurate before Retainage is released

<https://saws.smwvb.com>



Communication Reminders

- There should not be any communication with the following:
 - ✓ Design Engineer (Kimley-Horn)
 - ✓ SAWS Project Manager or Project Engineer
 - ✓ Any other SAWS staff
 - ✓ City Council member or staff
 - ✓ SAWS Board of Trustees
- This includes phone calls, emails, letters, or any direct or indirect discussion of the Proposal

Proposal Packet Preparation

- Utilize Evaluation Criteria Forms within the Supplemental Instructions to Respondents which are required in order to submit (SIR I-27)
- Respondent should use the forms to confirm that projects submitted are similar projects and meet the requirements
- Requirements vary for all 3 projects (see SIR)
- Point of contact should be the Utility, Municipality or Tank Owner (not the design engineer)
- Work performed should be by the contractor as the prime (not as a subcontractor)
- Reference contact information should be verified prior to submitting (failure to confirm may result in a reduction in points)

Proposal Packet Preparation

- Submit hard copies (1 original and 7 copies)
 - Copies differ from Original
- Include a USB flash drive of the original proposal; include all pages except GFEP & Price Proposal
- Utilize the Proposal Packet Checklist within the specifications
- Addenda are acknowledged on the Price Proposal
- Ensure Mob does not exceed the percentage noted
- Price Proposal includes Supplementary Unit Prices which should also be calculated

Vendor Registration & Notification (VRN)

- Please register through SAWS Vendor Registration Program on the SAWS website at www.saws.org to ensure access to the latest information.
- To receive updates on specific projects, registered vendors must 'Subscribe' to the project by selecting the project, and clicking 'Subscribe' under the Notify Me box.
- Addendum I was posted on 12/3 which included change to project estimate



Notify Me

Receive updates sent straight to your inbox.

Subscribe

Key Reminders

- All questions should be sent in writing to the corresponding Contract Administrator by email or fax.
- Please identify the project by its associated solicitation number.
- Contractors should not contact the SAWS project engineer, the consultants for this project or any other SAWS staff up until Board award.
- Late proposals will not be accepted and will be returned unopened.
- If mailing proposals, ensure that sufficient time is allowed for the package to reach SAWS.
- If proposals will be delivered in person to SAWS, Respondents should allow sufficient travel time, as well as time to check in at the guard station.

Project Location Map

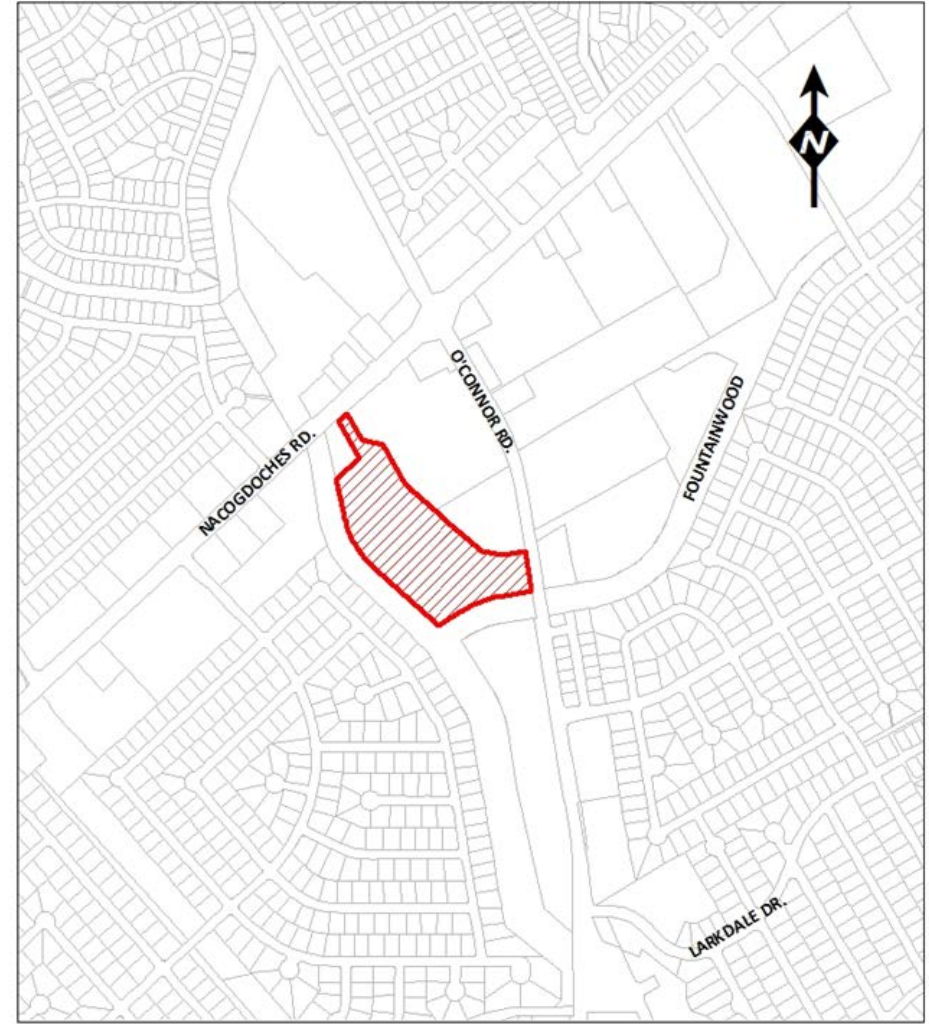
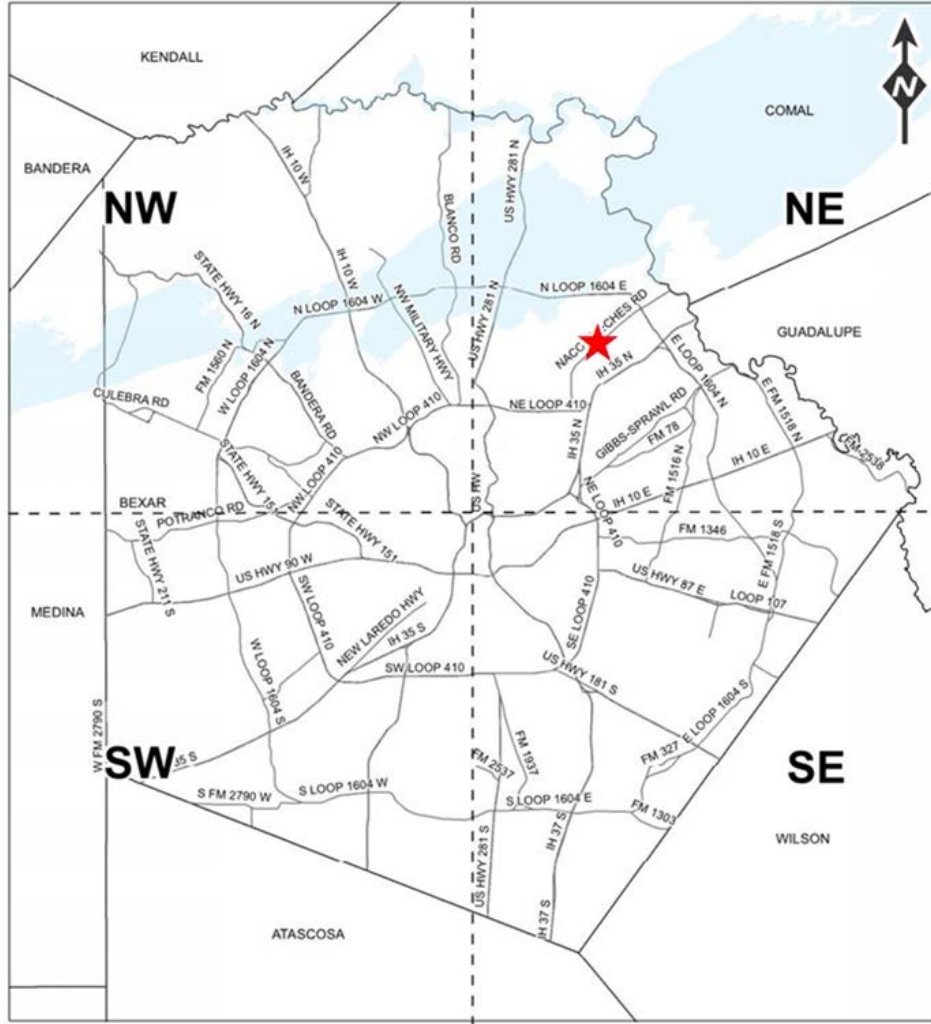

Naco Ground Storage Tank Rehabilitation Project



Contract Requirements

Supplemental Conditions

- Contractor shall perform the Work with its own organization on at least 40% of the total original contract price.
- Liquidated damages will be assessed at \$1,024 per day for final completion extending beyond contract time of all Project Phases.
- Key Personnel as defined in contract documents shall be dedicated exclusively to this project and shall not be diverted to other projects without written consent of owner.

Contract Background

Special Conditions:

- Remaining Work Memorandum (Addendum I)
- Contractor is responsible for delays due to resubmittals.
- Costs associated with additional inspections of failed work will be the Contractor's responsibility.
- Contractor agrees to cooperate and coordinate it's work with other contractor(s) in the project area.

Contract Background

Outlines the key portions of work that require significant effort or rework for completion:

- Weir Box – Entire removal and replacement
- Interior Roof to Rafter Connections – Touchup coatings repairs and additional coatings
- Interior Floor Coatings – Complete removal and replacement
- 36-inch Manway – Complete removal and replacement

Project Details

Scope of Work

- Clean Site
- Complete blasting and removal of exterior coating
- Exterior Coatings
- Weir Box Removal and Replacement
- 36-inch Manway Removal and Replacement
- Miscellaneous Weld Repairs
- Interior Coatings Repair
- Installation of Appurtenances (Tank Accessories, Cathodic Protection, etc.)

Unique Project Features

- Existing Incomplete Project – Required to check and complete work by others
- Interior Coating Repairs – Contractor will be required to Holiday Test existing interior coating and make repairs where necessary
- Site cleanup and restoration based on current conditions left by previous contractor
- Tank Accessories are located on site – Vent, Access Hatches, Vandal Deterrent, and others. Refer to Plans for equipment that is already onsite.

Contact Information

<u>Contact Name</u>	<u>Title</u>	<u>Telephone Number</u>	<u>Email address</u>
Fred Flores	Contract Administrator	210-233-3404	Fred.Flores@saws.org
Marisol Robles	SMWVB Program Manager	210-233-3420	Marisol.Robles@saws.org

QUESTIONS?

Oral statements or discussion during the pre-proposal meeting today will not be binding, nor will it change or affect the terms or conditions within the Plans and Specifications of this Project. Changes, if any, will be addressed in writing only via an Addendum.

Non-Mandatory Site Visit

Non-Mandatory Site visit immediately following this meeting:

SAWS Naco Tank Facility

13655 O'Connor Rd.

San Antonio, TX 78233

Naco Ground Storage Tank Rehabilitation Project

Kathleen Price, P.E.

Manager – Engineering

Michael Robbins, E.I.T.

Graduate Engineer II

Fred Flores

Contract Administrator

Kendall NeSmith, P.E.

Engineer of Record

Marisol V. Robles

SMWVB Program Manager

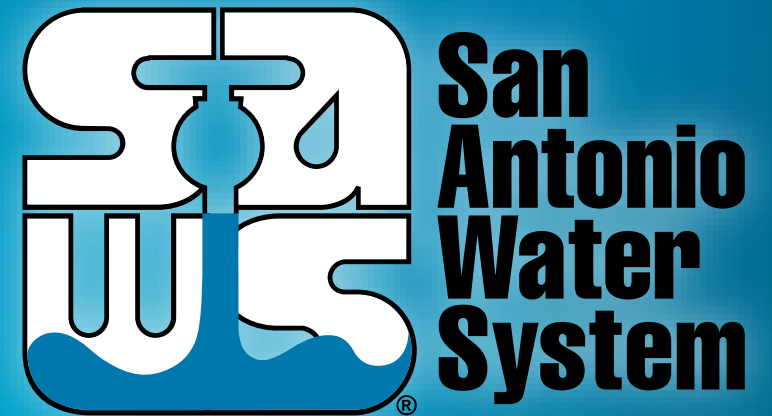

Pre-Proposal Meeting

December 9, 2019

MAKING SAN ANTONIO
WATERFUL 